

# Steel - 30 x d - coated

RECOMMENDATION FOR USE  
● Excellent | ● Good | ○ Acceptable | ☒ Not recommended

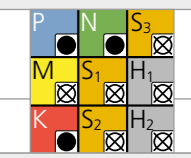

## DRILLING WITH EXTERNAL COOLING | CUTTING DATA OVERVIEW

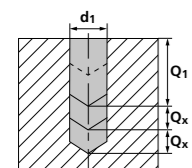
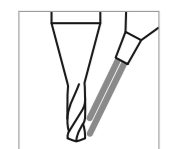

Materials group	Material	Mat. no.	DIN	AISI/ASTM/UNS	v <sub>c</sub> [m/min]				Q <sub>1</sub>	Q <sub>2</sub>	f [mm/rev]								
					Ød1 ≤ 0.4		Ød1 > 0.4				0.2 mm	0.3 mm	Ød1		0.8 mm	1.0 mm–1.2 mm			
					Mid	High	Mid	High			f	f	0.4 mm 1/64"	0.6 mm	1/32"	f			
P	Unalloyed carbon steel Rm < 800 N/mm <sup>2</sup>	1.0301	C10	AISI 1010															
		1.0401	C15	AISI 1015															
		1.1191	C45E/CK45	AISI 1045															
		1.0044	S275JR	AISI 1020															
		1.0715	11SMn30	AISI 1215															
		1.5752	15NiCr13	ASTM 3415 / AISI 3310															
	Low alloyed steel Rm > 900 N/mm <sup>2</sup>	1.7131	16MnCr5	AISI 5115															
		1.3505	100Cr6	AISI 52100															
		1.7225	42CrMo4	AISI 4140															
		1.2842	90MnCrV8	AISI O2															
		1.2379	X153CrMoV12	AISI D2															
		1.2436	X210CrW12	AISI D4/D6															
High alloyed tool steel Rm < 1200 N/mm <sup>2</sup>	1.3343	HS6-5-2C	AISI M2 / UNS T11302																
	1.3355	HS18-0-1	AISI T1 / UNS T12001																
M	Stainless steel ferritic	1.4016	X6Cr17	AISI 430 / UNS S43000															
		1.4105	X6CrMoS17	AISI 430F															
	Stainless steel martensitic	1.4034	X46Cr13	AISI 420C															
		1.4112	X90CrMoV18	AISI 440B															
	Stainless steel martensitic – PH	1.4542	X5CrNiCuNb 16-4	AISI 630 / ASTM 17-4 PH															
		1.4545	X5CrNiCuNb 15-5	ASTM 15-5 PH															
	Stainless steel austenitic	1.4301	X5CrNi 18-10	AISI 304															
		1.4435	X2CrNiMo 18-14-3	AISI 316L															
1.4441		X2CrNiMo 18-15-3	AISI 316LM																
	1.4539	X1NiCrMoCu 25-20-5	AISI 904L																
K	Cast iron	0.6020	GG20	ASTM 30															
		0.6030	GG30	ASTM 40B															
		0.7040	GGG40	ASTM 60-40-18															
		0.7060	GGG60	ASTM 80-60-03															
N	Aluminium alloy wrought	3.2315	AlMgSi1	ASTM 6351															
		3.4365	AlZnMgCu1.5	ASTM 7075															
	Aluminium alloy cast	3.2163	GD-AlSi9Cu3	ASTM A380															
		3.2381	GD-AlSi10Mg	UNS A03590															
	Copper	2.004	Cu-OF / CW008A	UNS C10100															
		2.0065	Cu-ETP / CW004A	UNS C11000															
	Brass lead free	2.0321	CuZn37 CW508L	UNS C27400															
		2.036	CuZn40 CW509L	UNS C28000															
	Brass, Bronze Rm < 400 N/mm <sup>2</sup>	2.0401	CuZn39Pb3 / CW614N	UNS C38500															
		2.102	CuSn6	UNS C51900															
Bronze Rm < 600 N/mm <sup>2</sup>	2.0966	CuAl10Ni5Fe4	UNS C63000																
	2.096	CuAl9Mn2	UNS C63200																
S <sub>1</sub>	Super alloys	2.4856		Inconel 625															
		2.4668		Inconel 718															
		2.4617	NiMo28	Hastelloy B-2															
		2.4665	NiCr22Fe18Mo	Hastelloy X															
S <sub>2</sub>	Titanium pure	3.7035	Gr.2	ASTM B348 / F67															
		3.7065	Gr.4	ASTM B348 / F68															
S <sub>3</sub>	Titanium alloys	3.7165	TiAl6V4	ASTM B348 / F136															
		9.9367	TiAl6Nb7	ASTM F1295															
H <sub>1</sub>	Hardened steel < 55 HRC	1.2510	100MnCrMoW4	AISI O1															
		1.2379	X153CrMoV12	AISI D2															

Recommended: CrazyDrill Flex SST-Inox 30 x d1

Recommended: CrazyDrill Flex Titanium 30 x d1

Recommended: CrazyDrill Flex SST-Inox 30 x d1

Recommended: CrazyDrill Flex SST-Inox 30 x d1

Recommended: CrazyDrill Flex Titanium 30 x d1

Recommended: CrazyDrill Flex Titanium 30 x d1

Recommended: CrazyDrill Flex SST-Inox 30 x d1